

### 3 Projections On Top Of Head: PG 2512

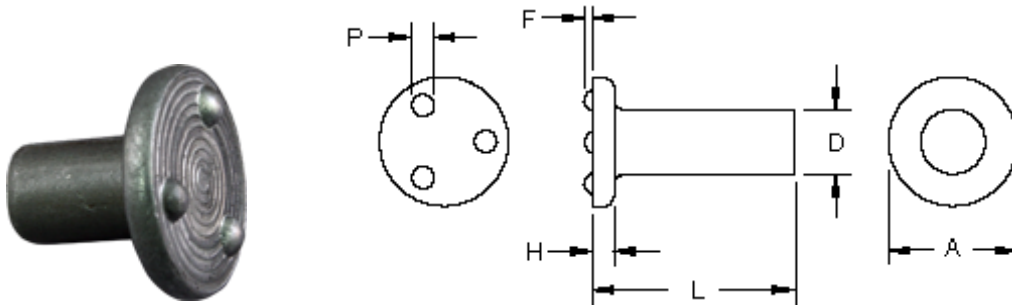

Length (in)	3/4
Head Diameter (in)	1/2
Body Diameter (in)	0.250
A (in)	0.500
Tol A (in)	+0.010 / -0.015
D (in)	0.250
Tol D (in)	+0.000 / -0.006
F (in)	0.040
Tol F (in)	+0.002 / -0.002
H (in)	0.078
Tol H (in)	+0.005 / -0.005
L (in)	0.750
Tol L (in)	+0.000 / -0.030
P (in)	0.100
Tol P (in)	+0.005 / -0.005
Material	C1010 High-Welding Quality, Low Carbon Steel
Finish	Plain, Unless Specified



**BUCKEYE FASTENERS COMPANY**

DISTRIBUTED BY



advancecomponents.com

972-446-5500